

£150,000

Cornflower Avenue, Shirebrook,



Welcome to **BuckleyBrown**, where every home is carefully presented, so you can explore with clarity and confidence.

BuckleyBrown
ESTATE AGENTS

SOLD BEFORE FULL MARKETING

"The property presents a sensible and balanced layout, with rooms that are well sized and arranged to make effective use of the available space, resulting in a comfortable and practical living environment."

- Jon Brown, Director



A property that works for you

A beautifully arranged terraced home offering stylish, well-proportioned living across two floors.

With a bright living room, separate dining space, two generous double bedrooms, and a modern bathroom, this home is perfectly suited for comfortable everyday living. Outside, enjoy the convenience of front parking and a landscaped rear garden—ideal for relaxing or entertaining.



Step Inside

This charming terraced property and discover a thoughtfully designed home that balances practicality with comfort.

The ground floor welcomes you with a central hallway leading into a bright and inviting living room at the front—perfect for unwinding after a long day. To the rear, the layout flows into a dedicated dining area and a well-sized kitchen, creating a natural hub for both everyday meals and entertaining. A convenient ground floor WC and useful storage add to the home's functionality.

Upstairs, the property continues to impress with two spacious double bedrooms, each offering excellent proportions and flexibility for a range of uses, whether as sleeping space, a home office, or guest accommodation. A centrally located bathroom serves both rooms and is neatly arranged for ease of use.

Externally, the home benefits from off-street parking to the front, while the rear reveals a landscaped garden—an ideal setting for outdoor dining, gardening, or simply enjoying some fresh air in a private space.

Overall, this is a well-balanced home with a practical layout, generous room sizes, and appealing outdoor space, making it an excellent choice for a variety of buyers.





BuckleyBrown
ESTATE AGENTS







Life in Shirebrook

Surrounded by open countryside and within easy reach of the edge of Sherwood Forest, Shirebrook is well placed for those who enjoy outdoor activities.

The surrounding area offers walking routes, woodland trails and green spaces, providing plenty of opportunities for leisure and relaxation. Local parks and nearby rural landscapes add to the town's appeal for families and anyone who values access to nature.

Despite its semi-rural setting, Shirebrook remains well connected. The town has its own railway station, offering services towards Nottingham and Worksop, while nearby road links such as the A60 and A632 provide access to Mansfield, Chesterfield and the wider East Midlands. The M1 motorway is also within easy reach, making the town a practical base for commuters travelling to larger employment centres such as Sheffield, Nottingham and Derby.



Ground Floor
32sq.m/344.14sq.ft
Approx

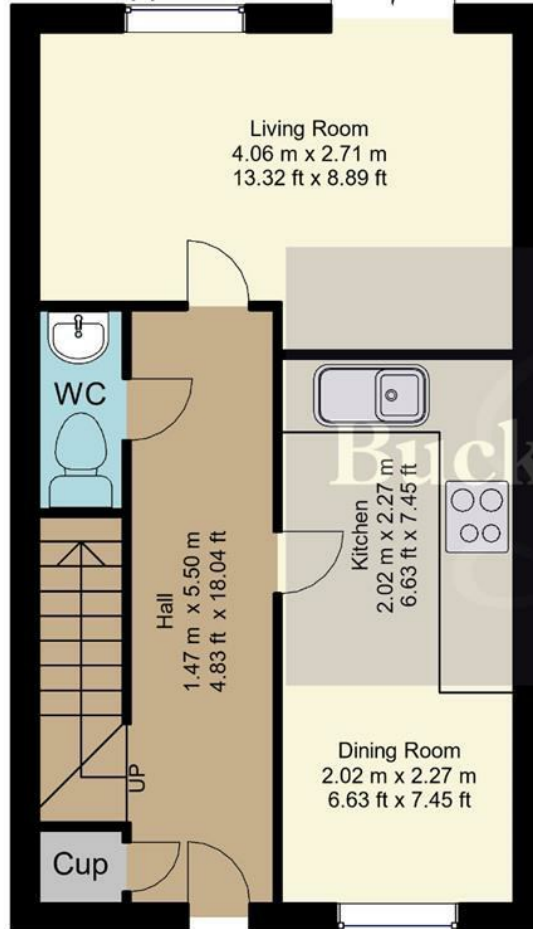

First Floor
42sq.m/454.30sq.ft
Approx

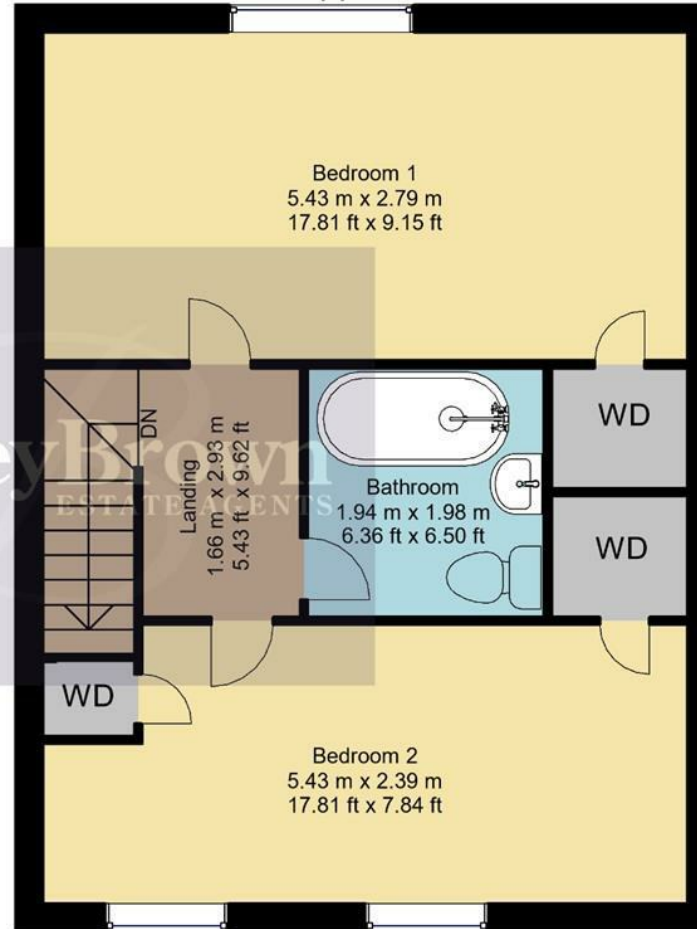

Whilst every attempt has been made to ensure the accuracy of the floor plan contained here, no responsibility is taken for incorrect measurements of doors, windows, appliances and room or any error, omission or misstatement. Exterior and interior walls are drawn to scale based on interior measurements. Any figure given is for initial guidance only and should not be relied on as basis of valuation. These plans are for marketing purposes only and should be used as such by any prospective purchase. Specially no guarantee is should not be relied on as a basis of valuation. These plans are for marketing purposes only and should be used as such by any prospective purchase. Specifically no guarantee is given on the total square footage of the property if quoted on this plan.
CC Ltd ©2018

Key Features

Attractive terraced property with well-balanced accommodation over two floors

Bright and Living room with access to the rear garden

Convenient ground floor WC

Modern kitchen with dining area

Two generous double bedrooms

Well-appointed first floor bathroom

Off-street parking to the front

Landscaped rear garden, perfect for outdoor relaxation

EPC Rating - B

Council Tax Band - A



These particulars are intended as a guide only and do not form part of any offer or contract. All descriptions, measurements, images and plans are provided for illustration purposes and should not be relied upon as statements of fact. Prospective purchasers should satisfy themselves as to the accuracy of the information. Buckley Brown Estate Agents accept no liability for any loss arising from reliance on these details.

© Buckley Brown Estate Agents 2026. All rights reserved.

Exceptional homes deserve
exceptional representation.

Let's Chat.

01623 633633

mansfield@buckleybrown.co.uk

buckleybrown.co.uk

BuckleyBrown
ESTATE AGENTS